

Fayetteville Public Library

An Informational Meeting about the Next Chapter
July 6, 7 and 8, 2016

The very existence of libraries affords the best evidence that we may yet have hope for the future of man. — T.S. Eliot

**What makes a
library great?**

THE OLD LIBRARY IS DEAD

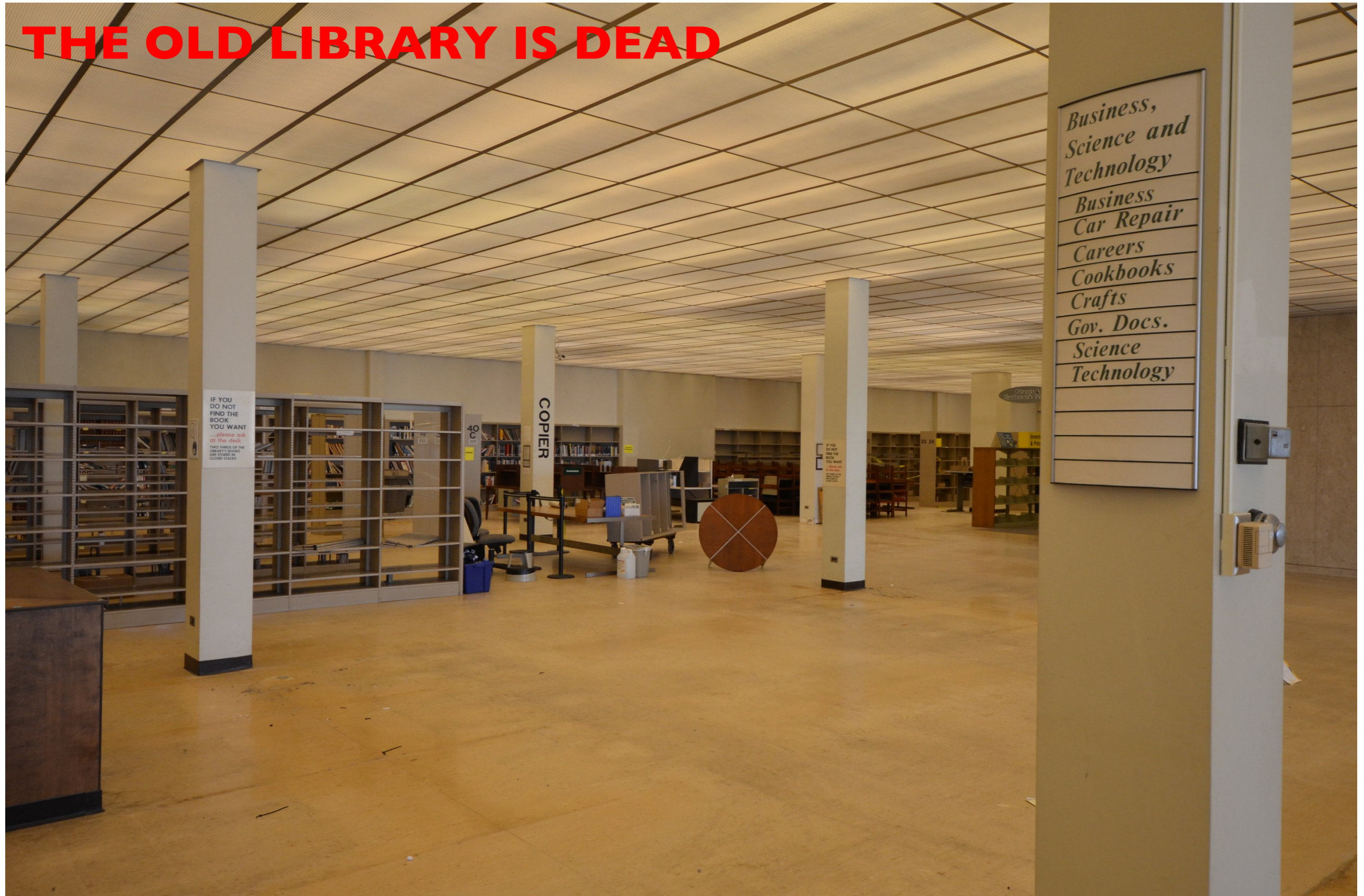

IF YOU DO NOT FIND THE BOOK YOU WANT
...please ask at the desk
TWO THIRDS OF THE LIBRARY'S BOOKS ARE STORED IN CLOSED STACKS

40 C

COPIER

IF YOU DO NOT FIND THE BOOK YOU WANT ...please ask at the desk

23 04

Business,
Science and
Technology

Business
Car Repair

Careers

Cookbooks

Crafts

Gov. Docs.

Science

Technology

**LIBRARY TRADITIONALLY DEFINED BY
WHAT LIES WITHIN ITS WALLS**





LEAD CHANGE

How can the institution of the library remain vital and healthy in an era of rapid change and economic uncertainty?

THE NEW LIBRARY IS VITAL AND THRIVING



create a destination/civic center



zoning

variety

daylight

privacy

delight

community

choice

















Hennepin County Library Maple Grove

Public Space



Madison Central Library

Model of sustainability

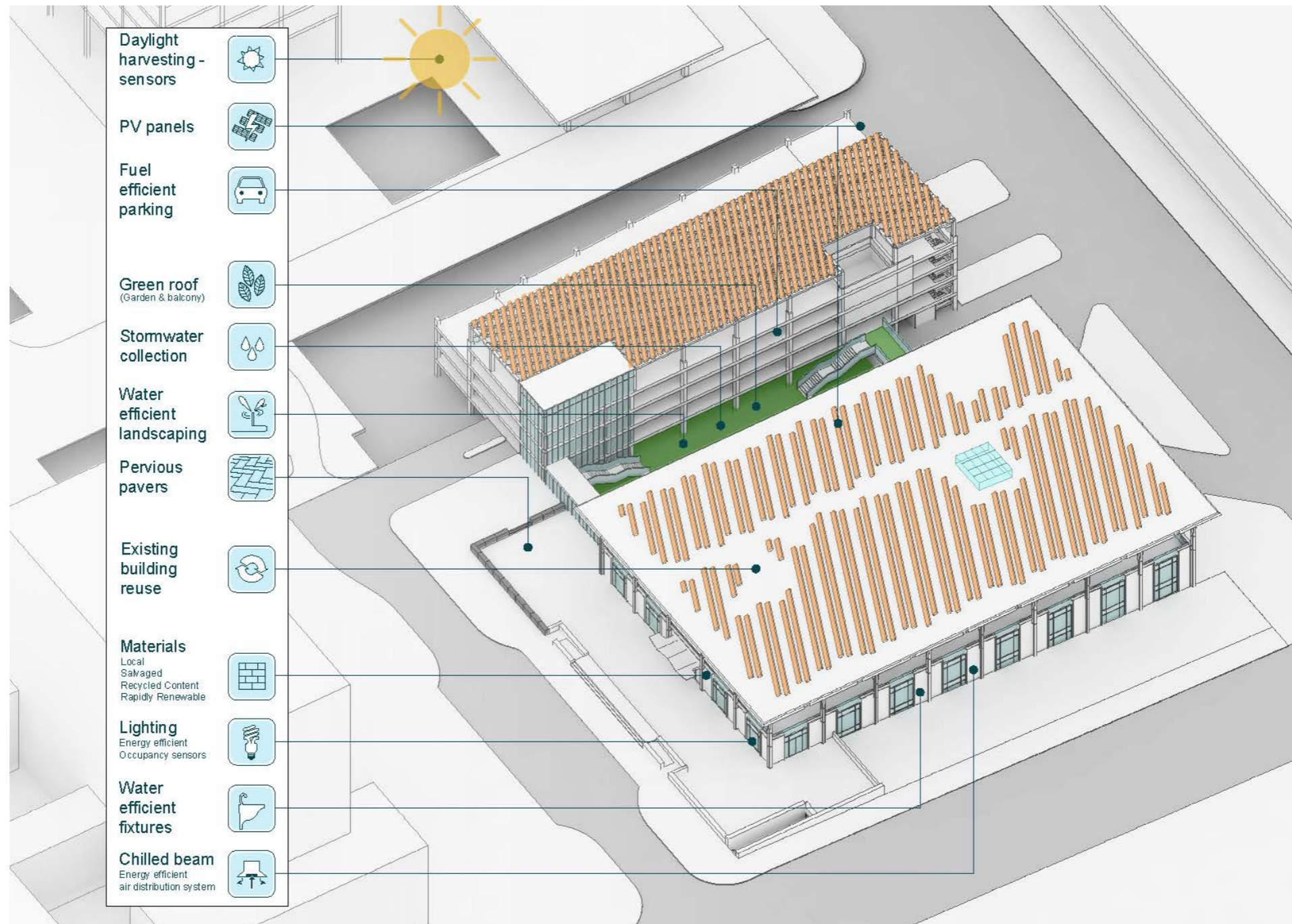

Tulsa City-County Central Library

Partners



Madison Central Library

Hands-on learning



Madison Central Library

Adaptability



Hennepin County Library Maple Grove

Workflow efficiency / flexibility



Ramsey County Roseville Library

Acoustics



McAllen Main Library

Connection to outdoor space



Hennepin County Library Maple Grove

Functional Efficiency



Ramsey County Roseville Library

Program Identity



Ramsey County Roseville Library

Clear Concept



McAllen Main Library

Natural Light



Saint Cloud Public Library

Design Process

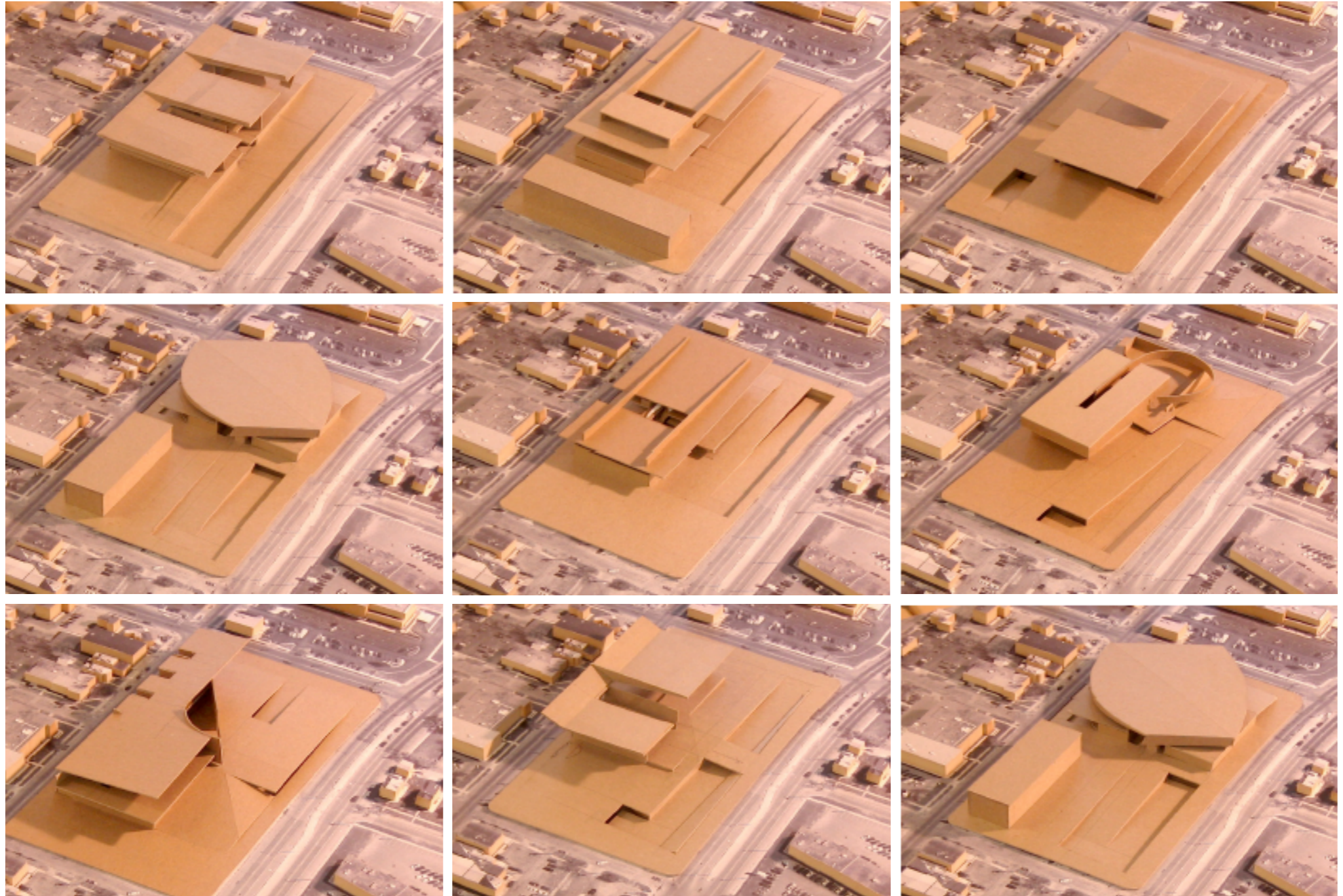

Broad and deep investigation





02/02/2008

Need

Serving People 2004 to 2015



44% increase in circulation



43% of circulation is Youth Services



619,000 visits in 2015



Use of Genealogy collection
up by 57%

Serving People 2004 to 2015



Inventory turns over 4X per year



184 people per hour

Serving People

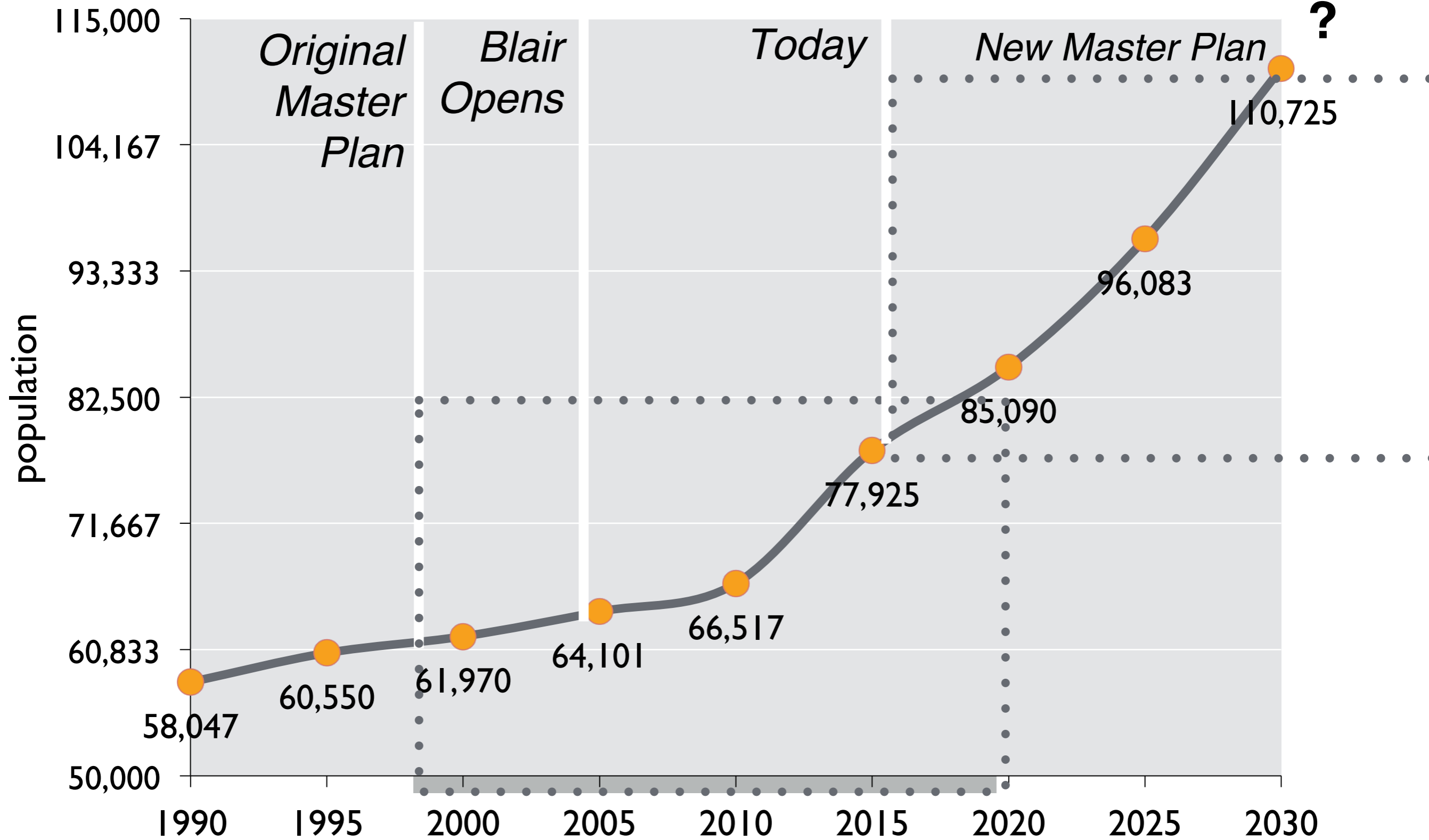

Serving People 2004 to 2030

64,000 to 115,000 folks

179%

Collection Inventory

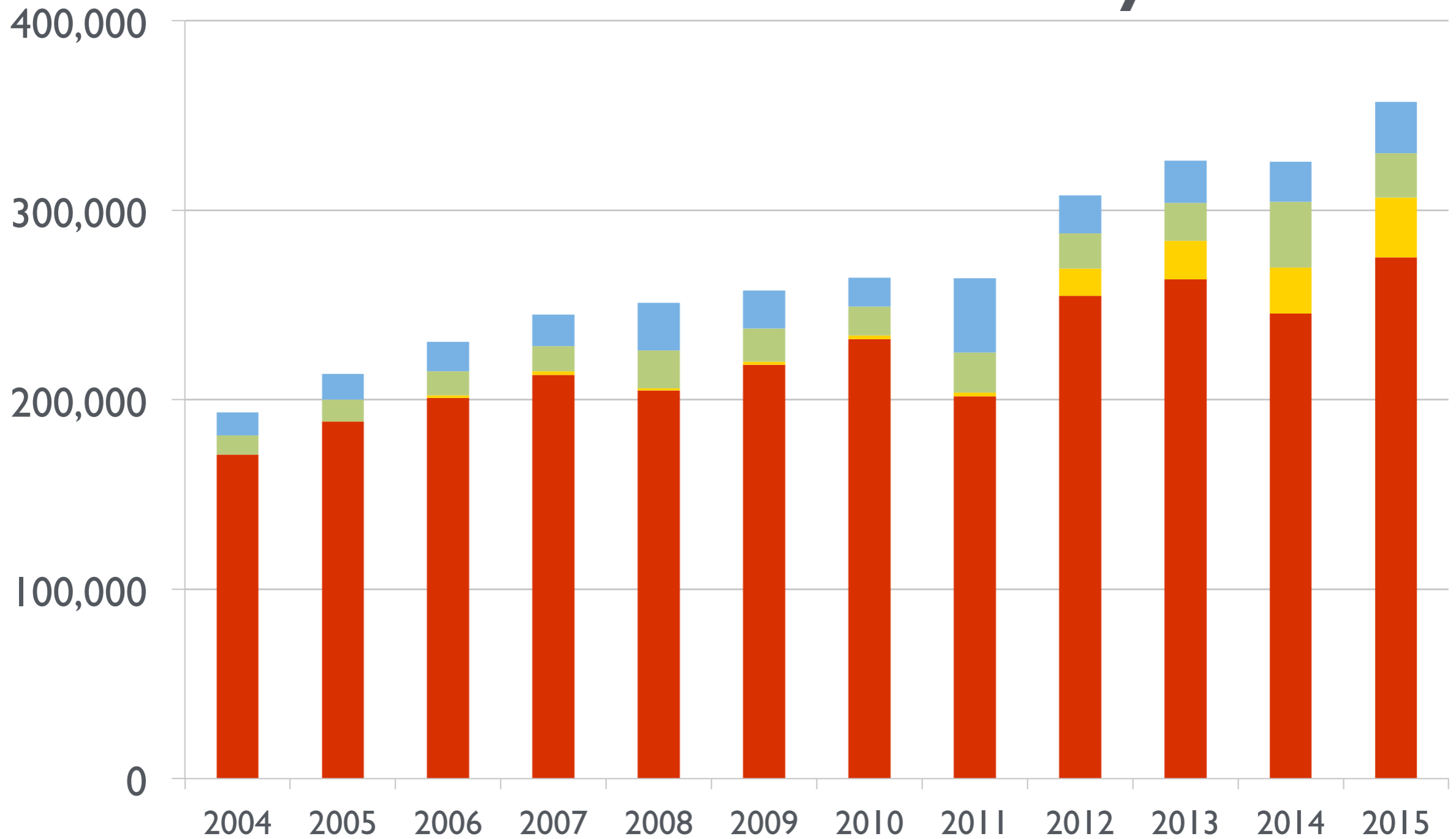

Print

Electronic Books

Audio

Video

Number of Programs Offered

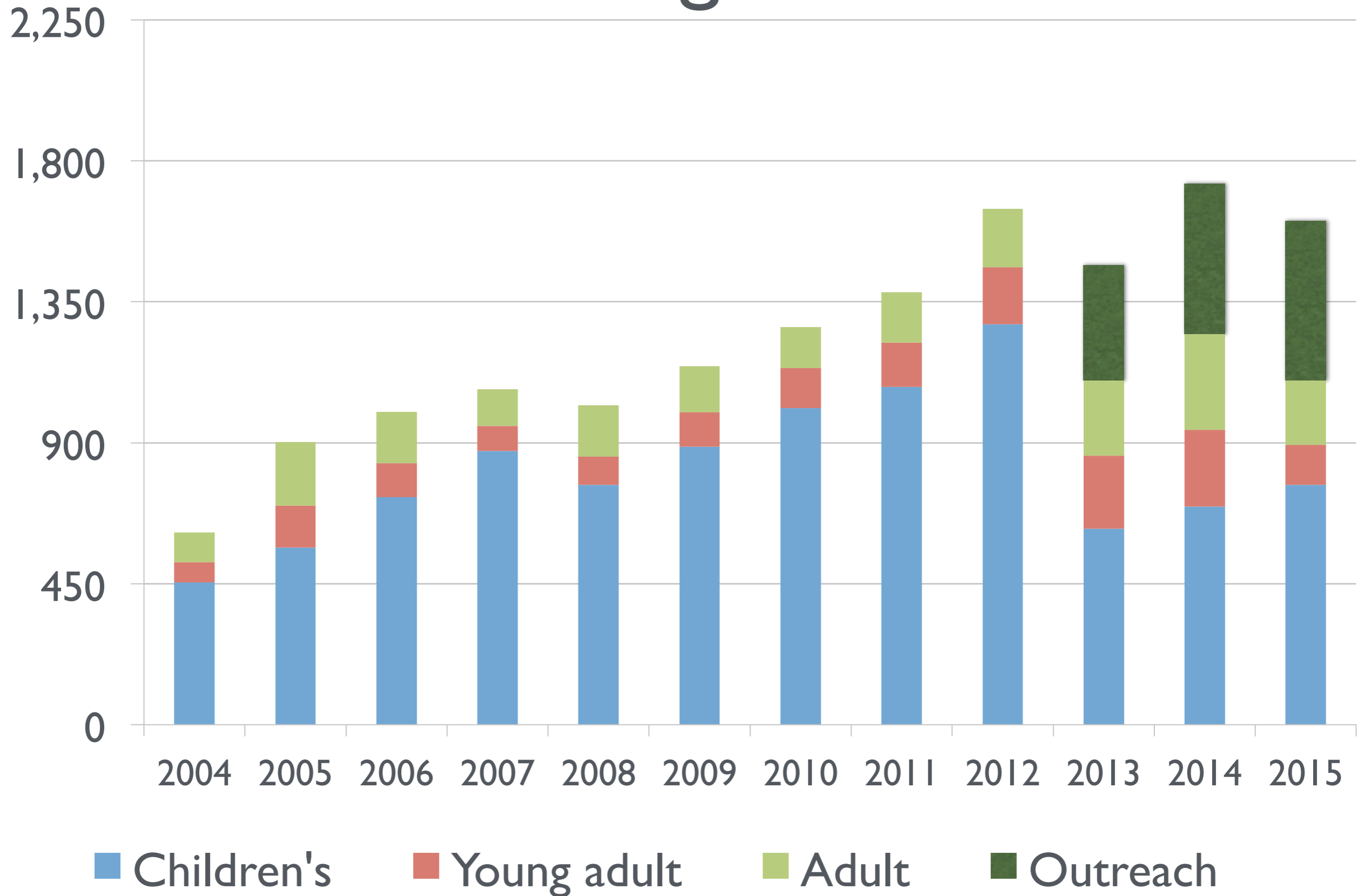

Attendance at Programs

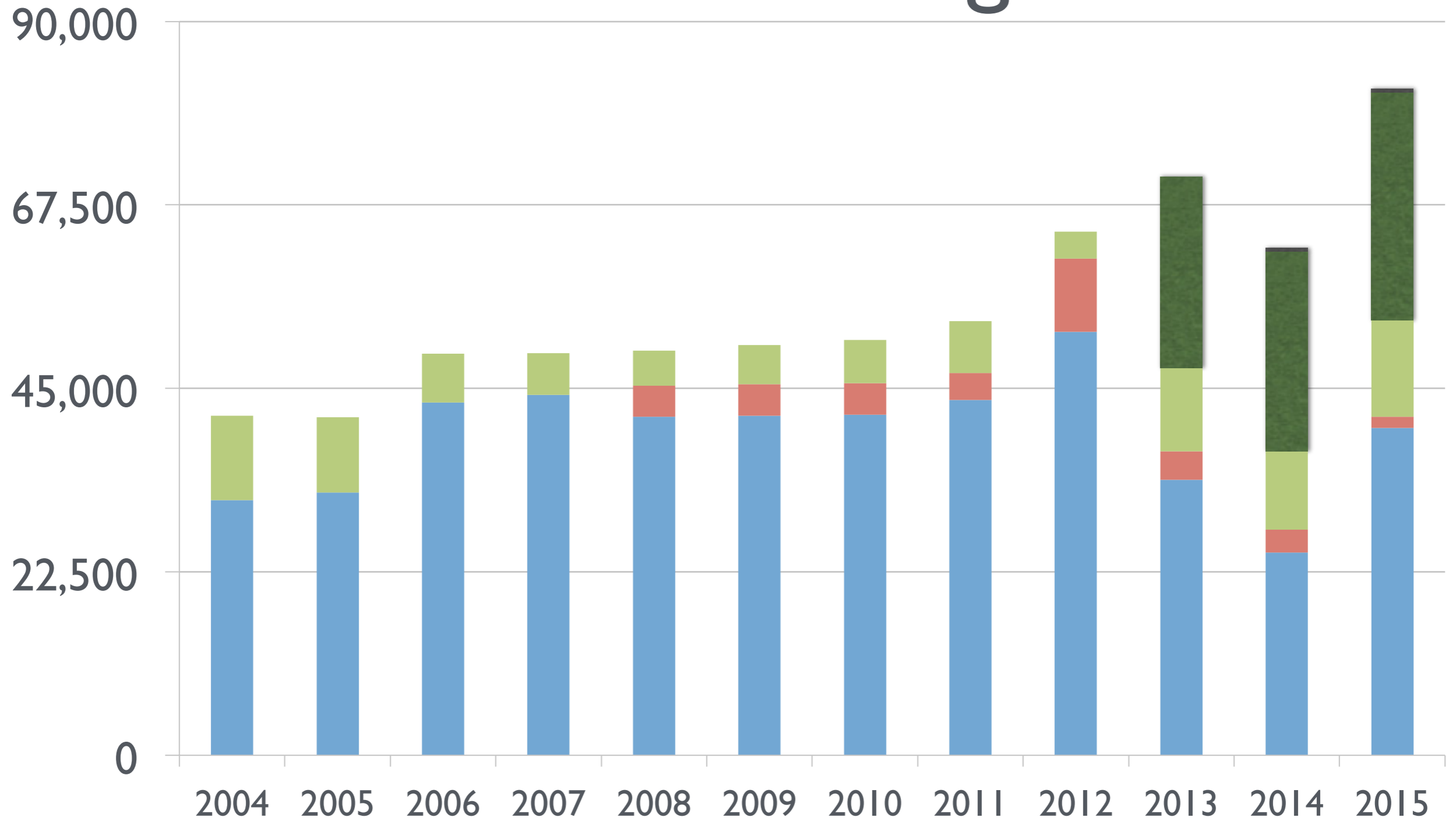

■ Children's ■ Young adult ■ Adult ■ Outreach ■ Livestream

Total Visits per Year

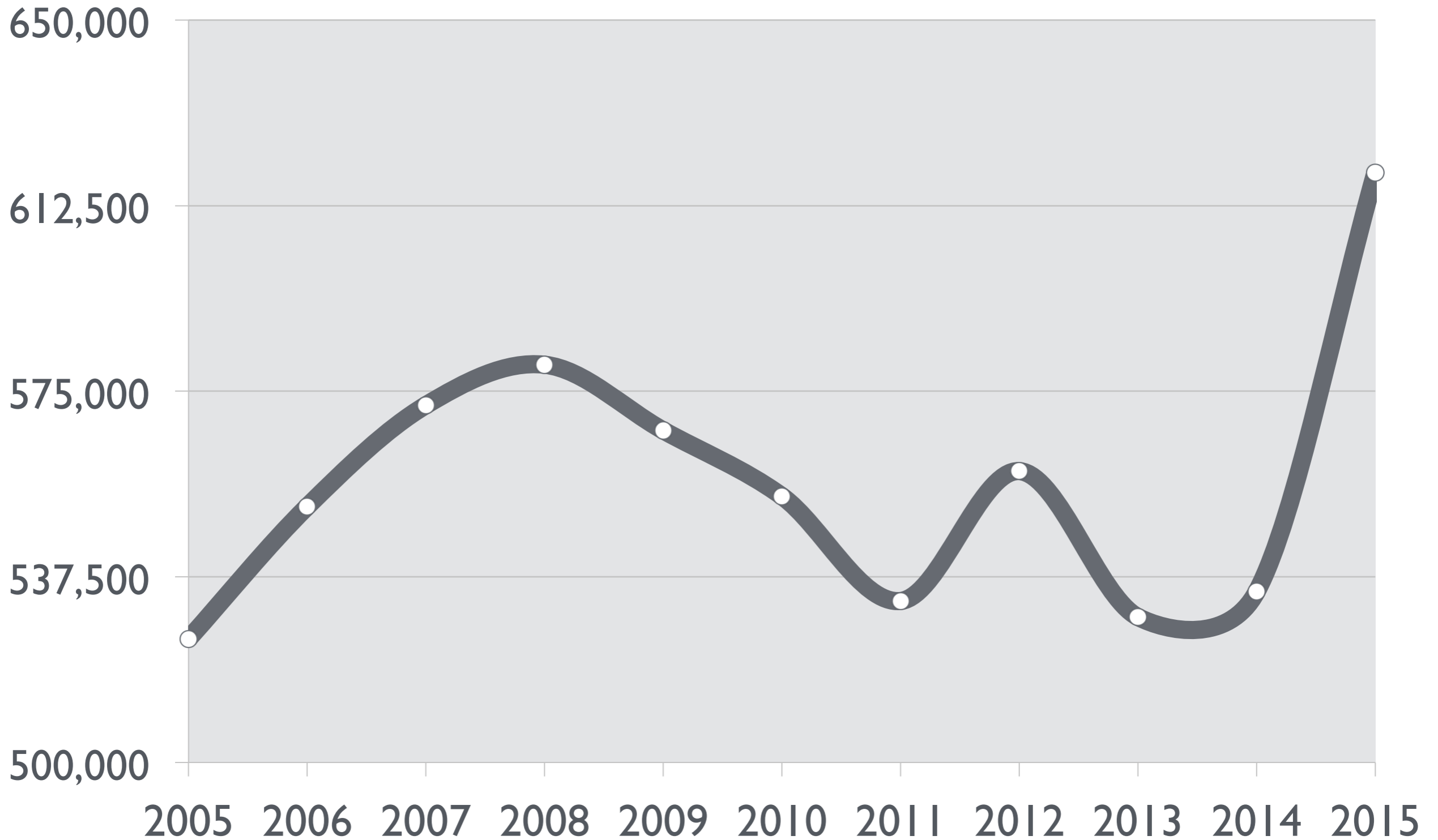

The Big Picture

- ▶ Space to meet, study and collaborate
- ▶ Double youth services
- ▶ Stand alone genealogy and local history
- ▶ More parking (220 to 435)

Cost

PROJECT COST

Project Budget	\$49,315,728	100%
Private Donations	\$22,815,728	46%
Millage Assessment	\$26,500,000	54%

Schedule

1998: First Master Plan 1998-2020

1998-2002: Public Process

2005: Library built to Master Plan

2012-13:

Step 1: Facility Assessment + Public Process

Step 2: Questions asked

Step 3: What is next?

Step 4: Recommendations

Step 5: Acceptance of Master Plan – planned for population of
125,000

2014-2016

Step 6: Resolution of Property Acquisition

2016

August 9

Step 7: Decision by the Public

September-December

Step 8: Public Engagement + Design (reflecting site decision)

2017

Step 9: Documentation and Bidding

2018-2020

Step 10: Construction of Expansion

2021

Step 11: Move-in + Renovate Existing

A Concept

Space Needs: Total

Collection	40,000	23.81%
Public Network Station	7,500	4.46%
Readers Seating Spaces	11,000	6.55%
Staff Work Spaces	11,000	6.55%
Meeting Room Spaces	12,000	7.14%
Multi-purpose Room	16,000	9.52%
Special Use Spaces	12,250	7.29%
Facilities and Outreach Support Support	9,000	5.36%
Circulation, Mechanical, Structure	49,250	29.32%
Total	168,000	100.00%

Area + Parking

1	Total New Public Services Area	70,550
2	Mechanical, Facilities and Storage	9,450
3	Existing Library	88,000
4	Grand Total Gross SF	168,000
5	Area called for in the Master Plan	168,000
	PARKING	
6	Total Parking Required	435
7	Parking Ratio (existing 2.35 spaces per 1000 sf)	2.60

- 1 Facilities
- 2 Parking Entry
- 3 Plaza
- 4 Parking

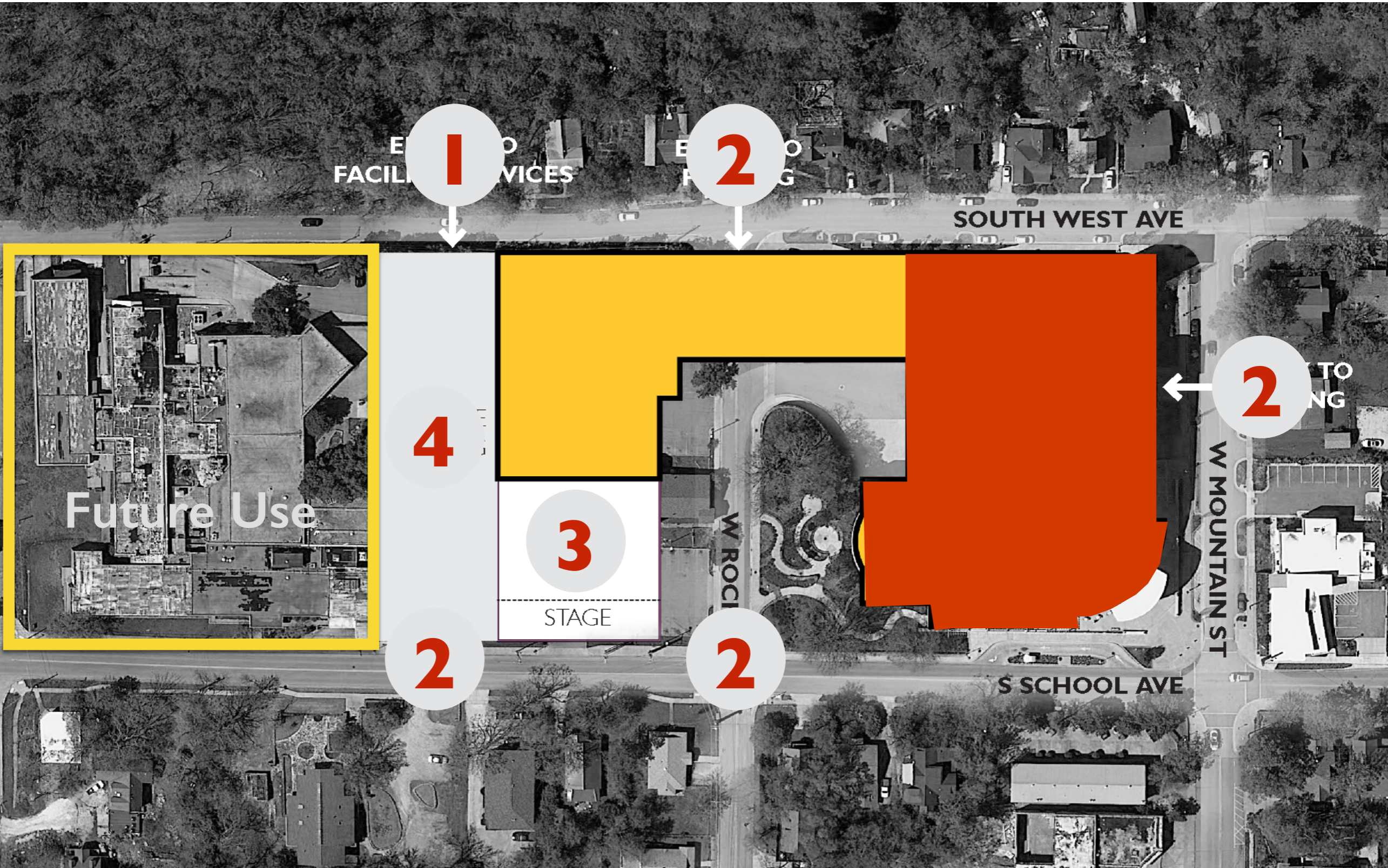

View towards Northwest

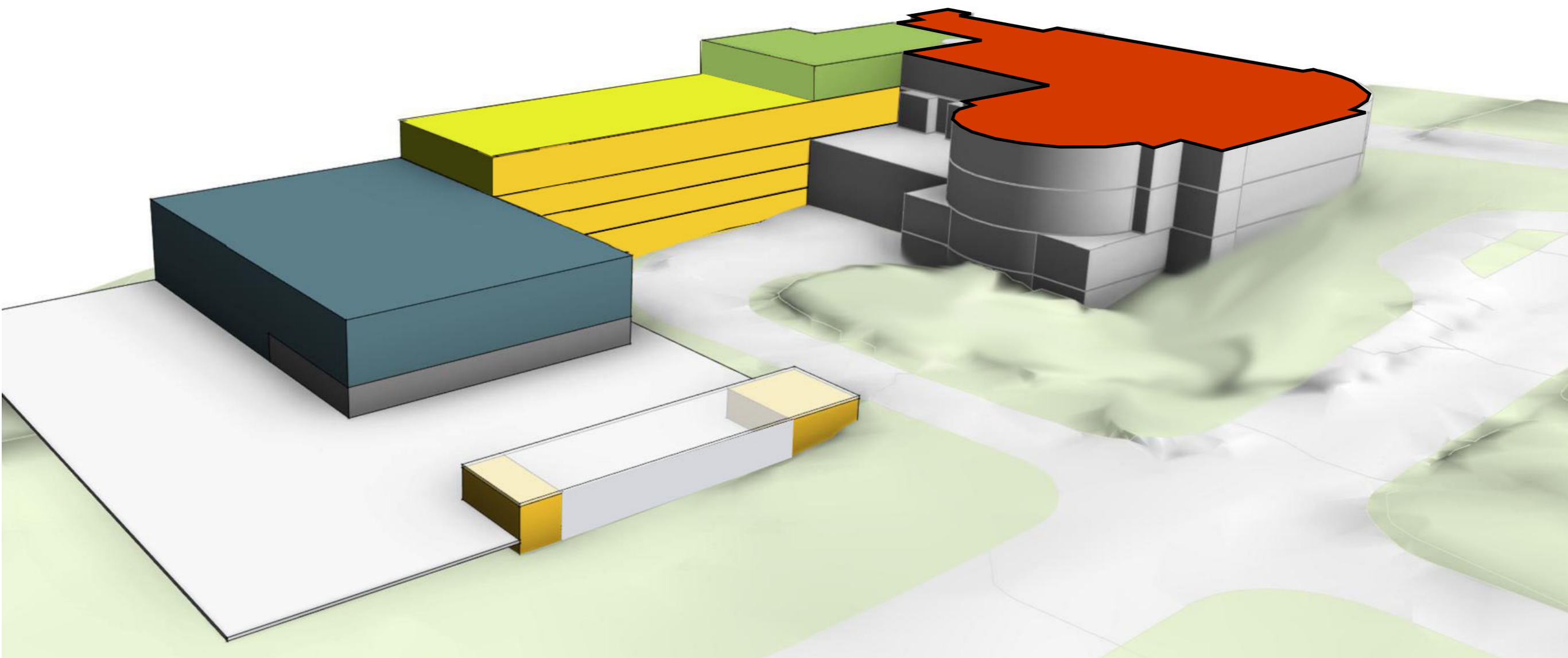

W MOUNTAIN:

1 Parking

2 Circulation

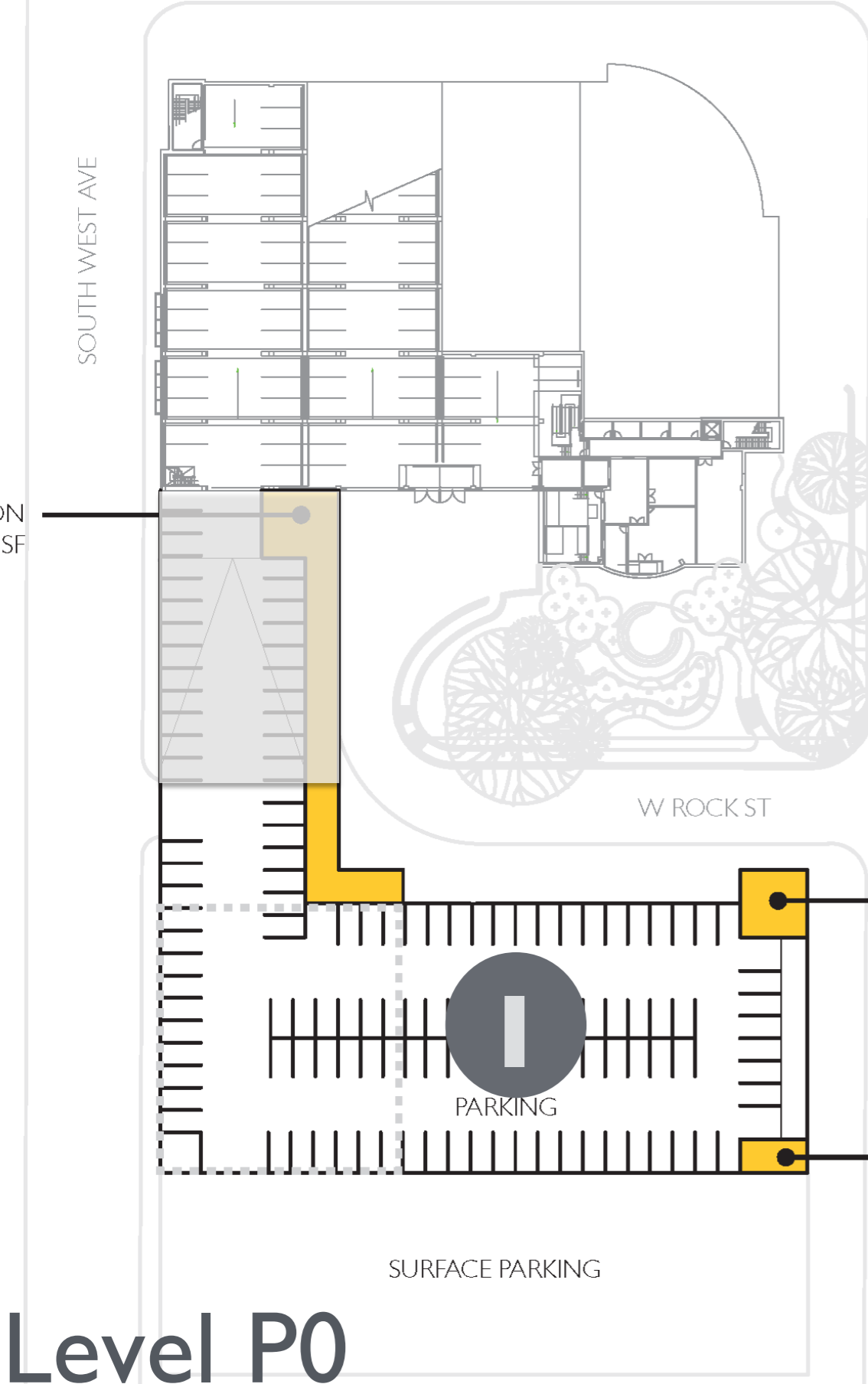

S SCHOOL AVE

W ROCK ST

2 TION

CIRCULATION
450 SF

Level P0

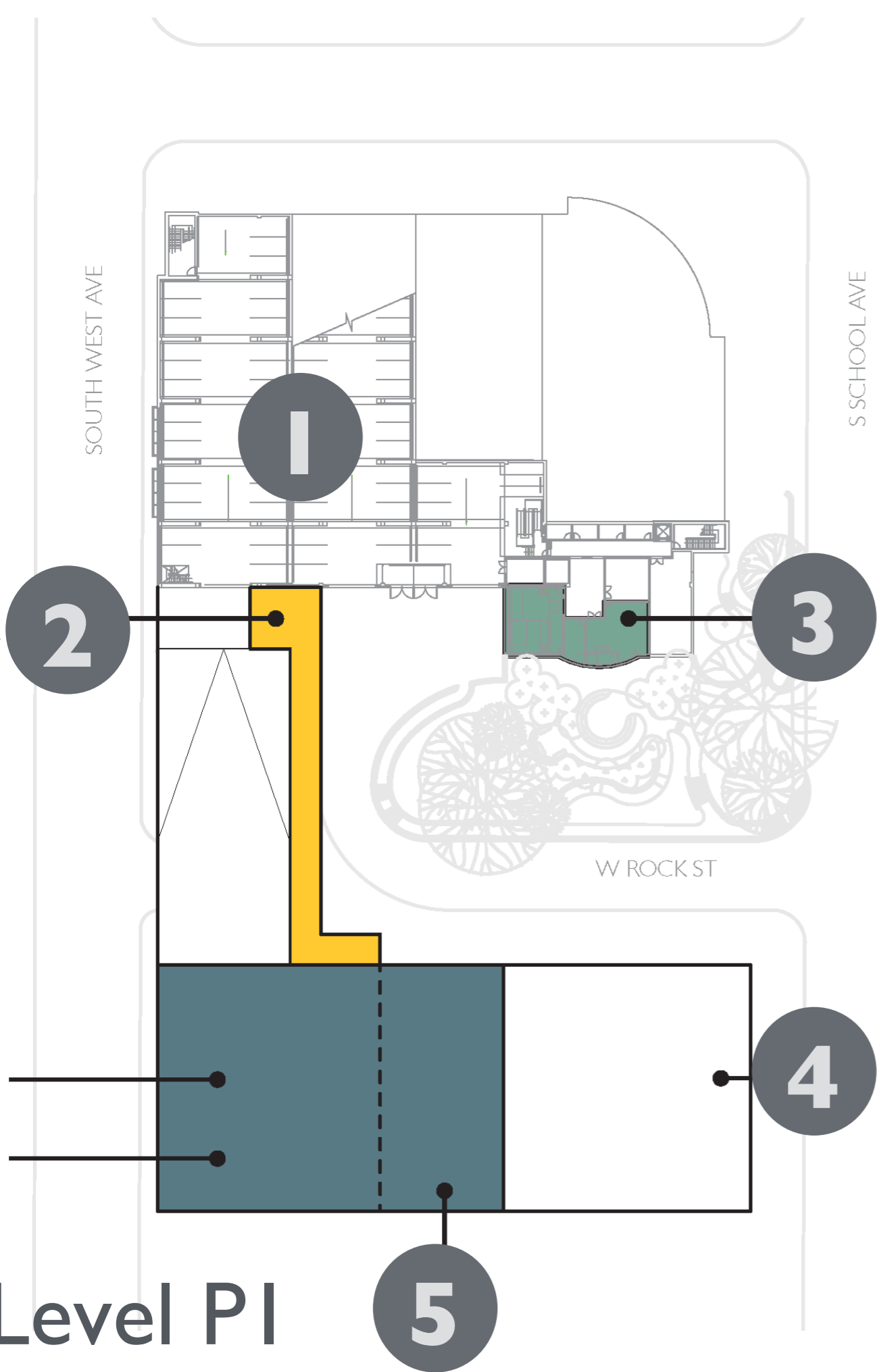

- 1** Parking
- 2** Entry
- 3** New Friend's Area
- 4** Library Plaza
- 5** Multi-purpose

Level PI

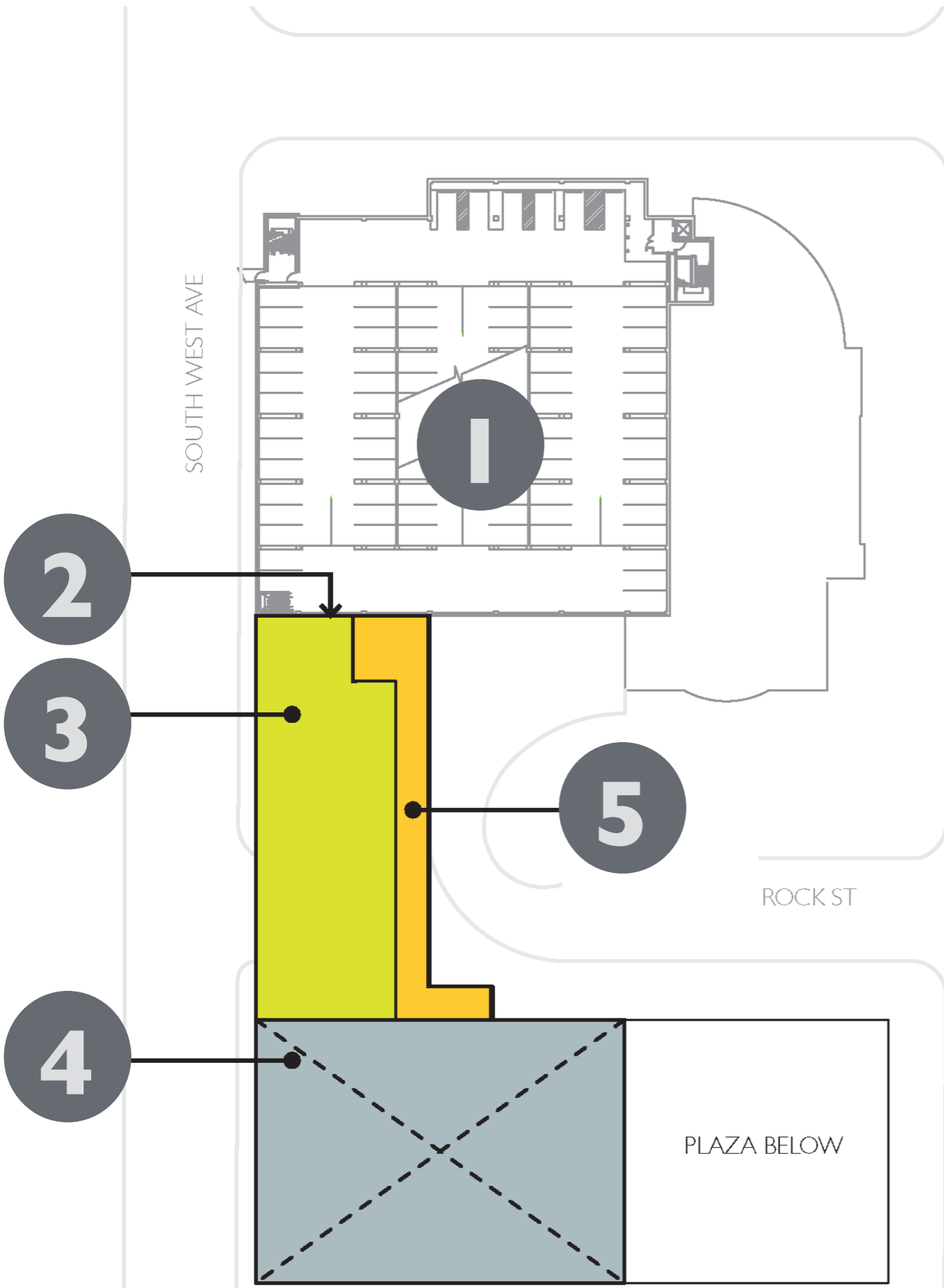

- 1** Parking
- 2** Entry to Youth
- 3** Youth Services
- 4** Multi-Purpose
- 5** Circulation

Level P2

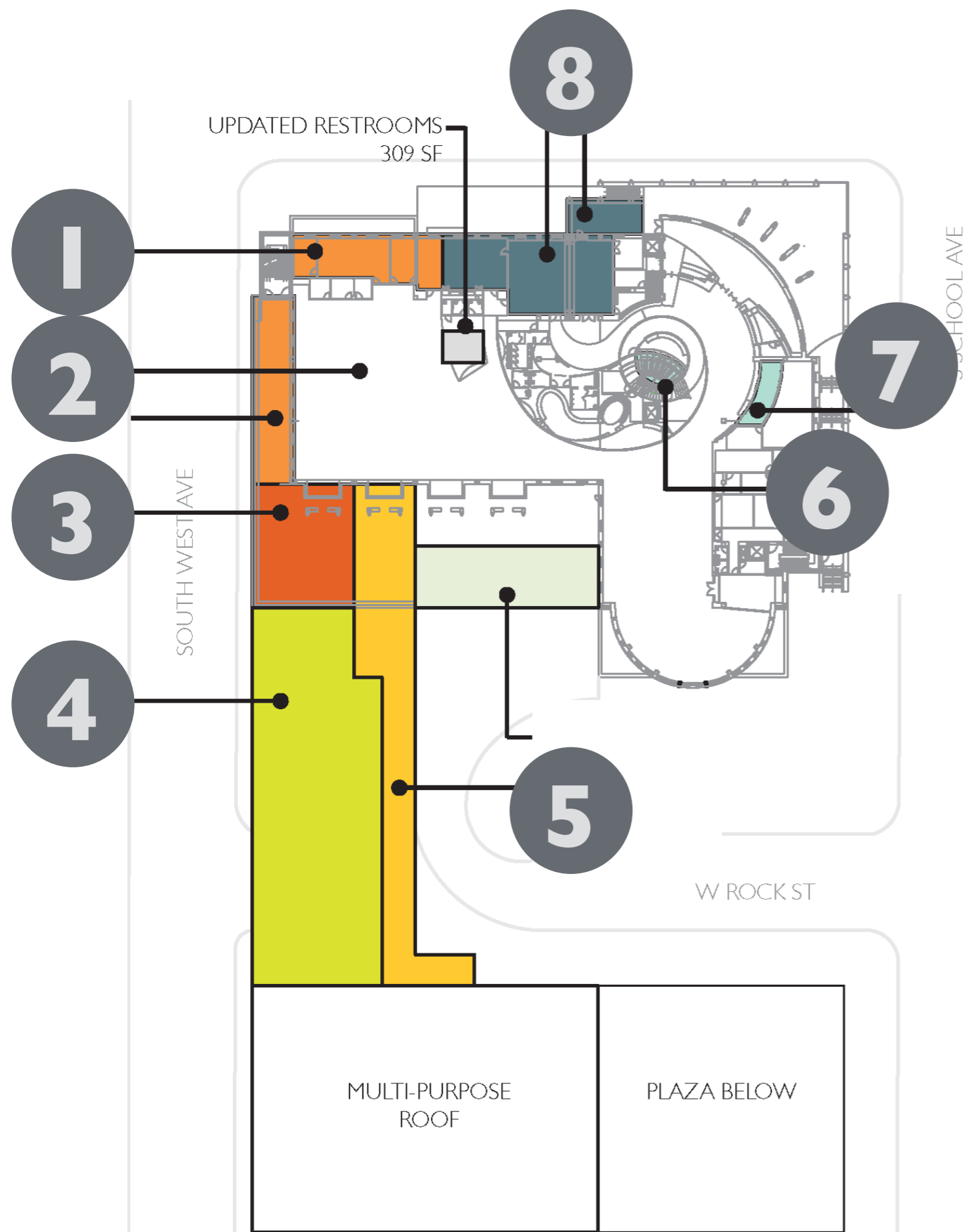

- 1 Meeting
- 2 Adult Services
- 3 Teens
- 4 Youth Services
- 5 Circulation
- 6 Holds
- 7 Bookstore
- 8 Exp. Walker

Level 300

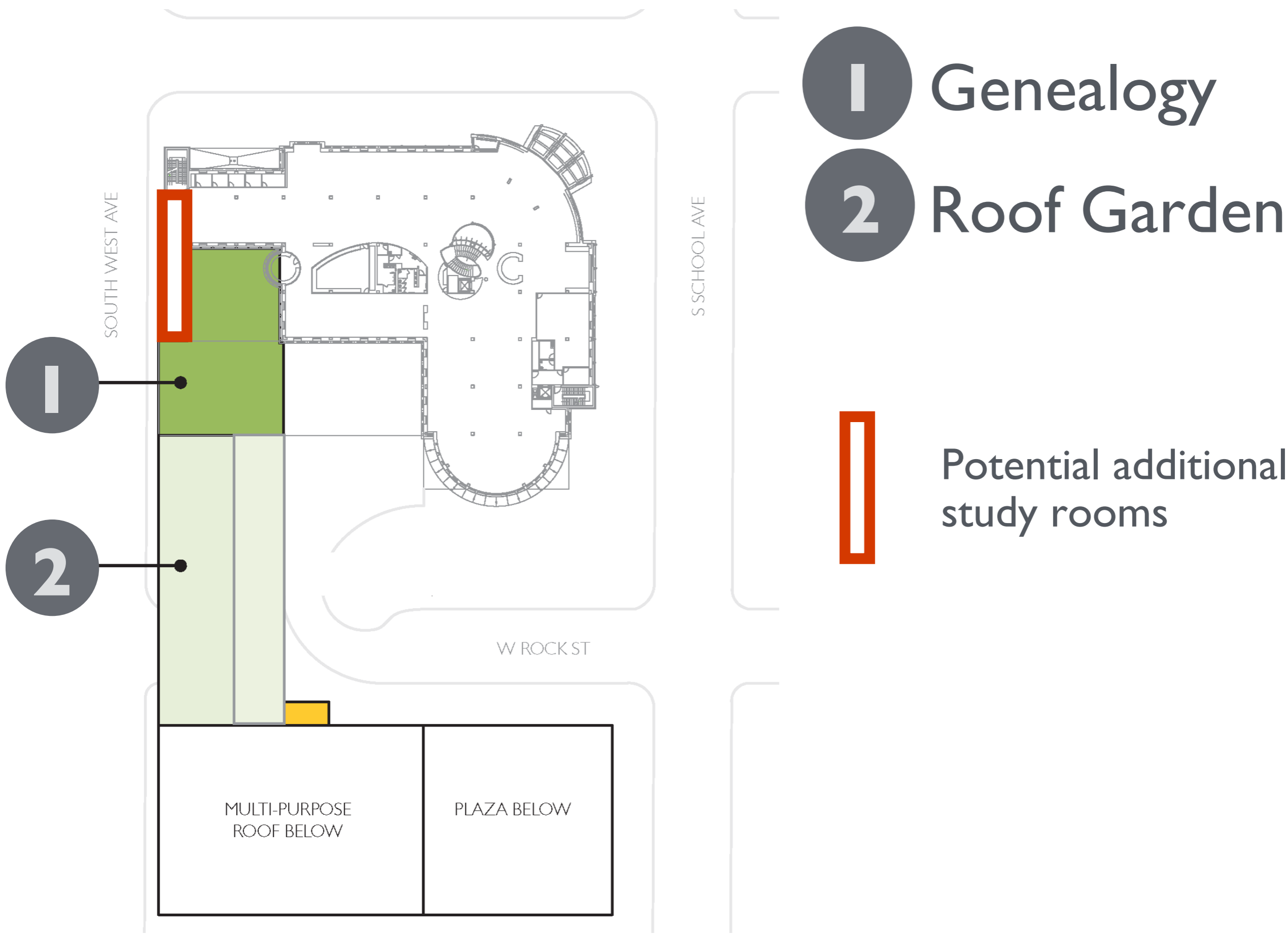

Level 400





Questions and Discussion

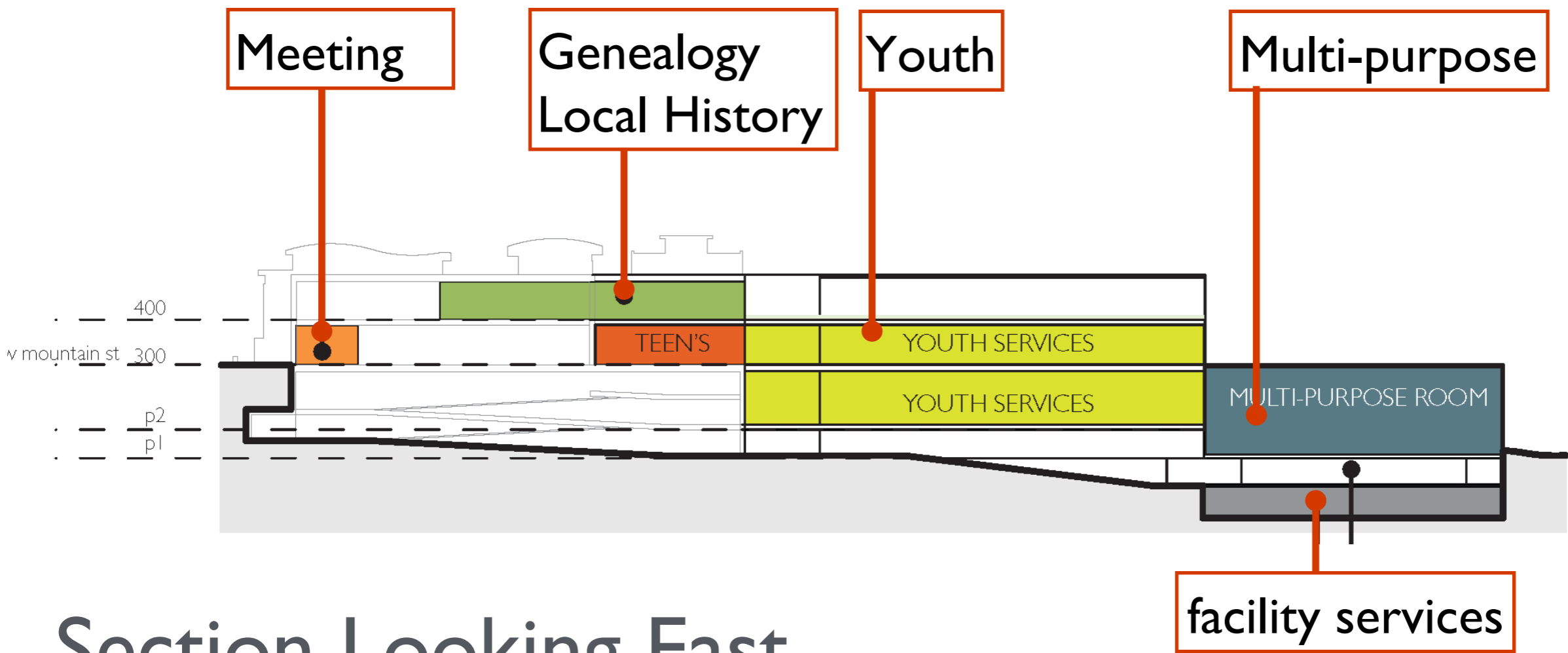

Section Looking East

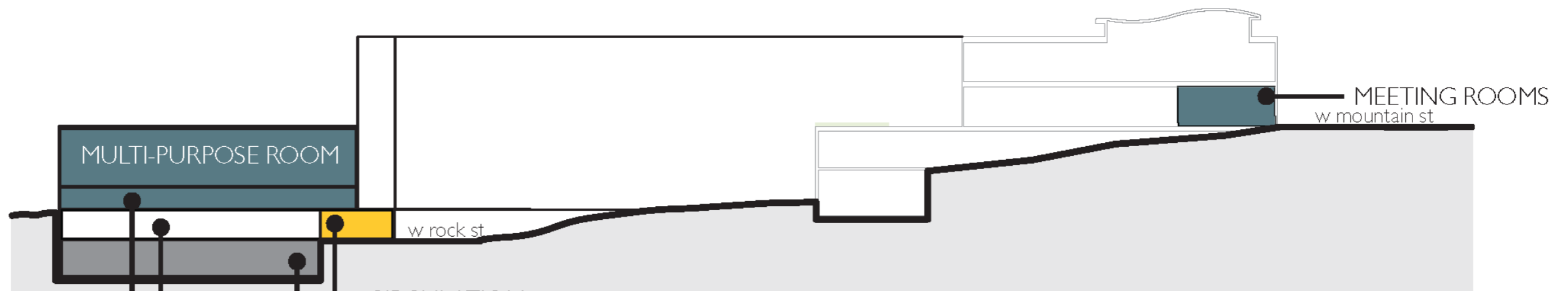

Section Looking West





